

MINUTES

Meeting: Corsham Community Area Transport Group (CATG)
Place: Virtual meeting via Microsoft Teams
Date: Thursday 1 July 2021
Time: 10.00 am

Please direct any enquiries to Kate Davey (Traffic Engineer), via email kate.davey@wiltshire.gov.uk

	Item	Update	Actions and recommendations	Who
	Date of meeting: 1st July 2021			
1.	Attendees and apologies			
	<p>Present: Cllr Ruth Hopkinson (Chair Wiltshire Council), Cllr Derek Walters (Wiltshire Council), Cllr Helen Belcher (Wiltshire Council), Kate Davey (Wiltshire Council Highways), Sarah Dearden (Wiltshire Council Highways), David Arnup (Wiltshire Council Highways), Gemma Winslow (Wiltshire Council Highways), James Whittleton (Corsham TC), Alun Crockford (Corsham TC), Robert Davies (Box PC), Anna Willard (Box PC), Richard Campbell (Box PC), Tony Clarke (Colerne PC), Peter Shaw (Lacock PC), Stuart Gregory (Lacock PC), Kerry Parker – Corsham BW Primary School Headteacher</p> <p>Apologies: Cllr Brian Mathew (Wiltshire Council), Spencer Drinkwater (Wiltshire Council), Ros Griffiths (Wiltshire Council), Steve Abbott (Corsham TC)</p>			
2.	Notes of last meeting			
		The notes of the last meeting held on 4 th March 2021 were accepted as a true record.	Noted and agreed.	

3.	Financial Position		
		See Finance sheet. 2021/22 allocation is £10,819.00 (previous years £10,951.00). 2020/21 underspend was £31,785.91 and the current commitments total £33,400.00 giving a remaining budget of £15,554.91.	Noted and agreed.
4.	Top 5 Priority Schemes		
a)	<p><u>Issue 6682</u></p> <p>Bridge between Lacock and Bowden Hill.</p>	<p>Site meeting held on 6th August 2019 with KD and Lacock Parish Council. Issues relating to pedestrian safety on the bridge were discussed and subsequent response sent to Lacock Parish Council detailing points considered and suggested possible solution. After group discussion Lacock PC request a reduction in speed limit near the bridge. Group agreed funding £2,500 for assessment. Lacock PC confirmed 25% contribution.</p> <p>Assessment complete. Design plan attached with a cost estimate of approximately £7,000 (CATG = £5,250) (25% = £1,750) for installation of revised speed limit. Group agreed funding for implementation. Lacock PC confirmed contribution. Legal documents with Traffic Regulation Order team for processing.</p> <p>Consultation period complete, no objections received therefore progress to implementation.</p> <p>Works order submitted with implementation date if 9th August 2021 for completion.</p>	<p><u>ACTION</u></p> <p>Remove from priority list into other priorities until works are complete.</p> <p>KD</p>

<p>b)</p>	<p><u>Issue 7043</u></p> <p>High Street, Lacock – High St/West St request for junction modifications.</p>	<p>Topographical survey has now been received and design work is underway to determine whether a mini roundabout is a workable solution at this location.</p> <p>At November group agreed funding of £5k for further design work, subject to Lacock PC confirmation of 25% contribution of £1250. Lacock PC have carried out consultation and attended meeting with KD in Jan 2020 to discuss alterations to the proposal. Subsequently see attached revised proposal for discussion at meeting.</p> <p>Lacock PC confirmed they have undertaken local consultation all of which was supportive of the proposal and therefore wish to proceed with further design work. PW raised concerns over the proposal and whether the National Trust had made comments. Lacock PC confirmed they were consulted and responded outside of the consultation period with objection to the proposal. BA confirmed support for the proposal. Lacock PC explained this is the first step in improving safety around the village. Group agreed to move proposal forward. Lacock PC confirmed contribution. PW expressed reservations for the project referring to the current consultation on Melksham Bypass and whether this will alleviate the traffic issues in Lacock village adequately. BA and LPC confirmed this is a separate issue relating to achieving formality of right of way at this junction and in turn slow traffic and improve safety. It is not believed the proposed bypass will make a significant difference to this site and what is trying to be achieved here.</p> <p>Drainage survey complete. Street Lighting survey complete. Lacock Parish Council to review and consult locally on lighting design. Currently, the deadline for substantive bids to be submitted is September 2021. Consider CATG/LPC contributions ready for bid process.</p>	<p><u>DISCUSSION</u></p> <p>LPC & KD discussed the street lighting options and confirmed overall scheme costs with the group. Group agreed contribution of £1,000 towards scheme.</p> <p><u>ACTIONS</u></p> <p>Confirm whether to have a Stage 1 RSA carried out at this point regarding the minimal lighting option.</p> <p>Carry out further local consultation including street lighting options.</p> <p>Confirm contribution towards scheme ready for substantive bid process.</p>	<p>LPC</p> <p>LPC</p> <p>LPC</p>
-----------	--	--	--	----------------------------------

<p>c)</p>	<p><u>Issue 6886</u></p> <p>A4 and Cross Keys Road junction. Request for reduction in speed limit.</p>	<p>Cost estimate for speed limit assessments is £2,500. This issue to be put on hold until the improvement works due to take place in the summer are complete. Corsham TC did confirm support & 25% contribution for assessment. Cross Keys construction project now finished. Group agreed funding for assessment. Corsham TC confirmed 25% contribution.</p> <p>The speed limit assessment is currently in progress with Atkins, however, there has been a delay in completing all of the analysis due to Covid-19 restrictions. Atkins are looking at a safe method to undertake journey time surveys which requires risk assessment approval. If approved they anticipate carrying out rest of assessment during December.</p> <p>SA raised concerns over recommendation requesting that section 1 be reduced to 40mph. Officers explained criteria relating to setting speed limit. Request for information on whether environmental impact assessment is carried out as part of the assessment. Group agreed to fund implementation with estimate of £7,000 (CATG £5,250). Subject to Corsham TC confirming 25% contribution of £1,750.</p> <p>Further discussions with Corsham TC since the last meeting. To be discussed at the meeting.</p>	<p><u>DISCUSSION</u></p> <p>Corsham TC confirmed they want the speed limit reduced to 40mph. They will be taking this issue to full council later in July. HB raised concerns about assessment recommendation. Once Corsham TC full council has met further correspondence will be submitted in due course.</p> <p>JW asked a process related question. KD confirmed if Corsham TC convince the rest of the group Councilors that a 40mph speed limit should be imposed, this will have to be escalated to the Head of Highways and Asset management.</p>	
-----------	---	--	--	--

<p>d)</p>	<p><u>5-20-4 / 5-20-6 (previously Issue 6876)</u></p> <p>Request for 20mph speed limit on residential streets around Corsham.</p>	<p>Cost estimate for speed limit assessments is £2,500. 25% contribution of £625. Corsham TC have now submitted plans for Corsham and Neston to be assessed. Group agreed funding. Corsham TC confirmed contribution.</p> <p>20mph speed limit assessment is in progress, however we are currently waiting to carry out the data collection/traffic surveys until the national restrictions surrounding Covid-19 are relaxed in order to get a true reading of 'normal' traffic speeds for the assessment. KD/JW discussed traffic surveys in January 2021 and agreed due to latest Covid-19 national lockdown to defer this work until the restrictions are eased and traffic returns to normal volumes.</p> <p>Assessment to be carried out as soon as possible. Currently, the timeframe is for traffic surveys to be undertaken over summer period and reports to be finalised in the autumn.</p>	<p><u>DISCUSSION</u> Corsham TC commented they would prefer surveys to be completed outside of school summer holiday. KD will request this to be considered.</p> <p><u>ACTION</u> Forward plans to Cllr Derek Walters regarding extent of survey.</p>	<p>KD</p>
<p>e)</p>	<p><u>5-19-2 (previously issue No 7105)</u></p> <p>Pickwick Road/Newlands Road Pedestrian Crossing.</p>	<p>Proposal plan attached to end of agenda. Estimate £700 (CATG: £525, 25% contribution: £175). Corsham TC asked for clarification on the proposed location of the warning sign. KD explained it was the most visible position with sufficient space to erect this sign. Group approved the funding proposal to installation. Corsham TC confirmed contribution.</p> <p>Work ready to implement and will be completed on site as soon as possible in the new financial year.</p> <p>Works order submitted and implementation is imminent.</p>	<p><u>ACTION</u> Remove from priority list into other priorities until works are complete.</p>	<p>KD</p>

<p>f)</p>	<p><u>Issue 5818</u> <u>Issue 6364</u></p> <p>Park Lane, Corsham - issues with parking in vicinity of Chestnut Grange & Purleigh Road.</p>	<p>Monitor parking issues as the developments on Park Lane progress and collate data received from local residents on the inappropriate parking at this location. Group agreed to leave on agenda and continue to monitor until developments have been completed. RH raised potential future issue with increased on street parking due to one unit wanting a change of use. New regulations allow for this without a requirement to apply or impose conditions, therefore this may lead to further parking issues at this location. DA confirmed patching sites have been submitted and are in hand. Group agreed to leave on the agenda for now and monitor.</p> <p>JW commented that most of the development is now complete and so now would be a good time to review this issue. Group agreed to take a holistic approach and revisit this issue.</p> <p>Site visit undertaken in June 2021. Options to be discussed at the meeting.</p>	<p><u>DISCUSSION</u> HB and AC confirmed the parking issue has become increasingly worse in the last few weeks.</p> <p><u>ACTIONS</u> Conduct further site visits to monitor parking situation.</p> <p>Collect photographic evident when visiting this area.</p>	<p>SD</p> <p>GW</p>
<p>g)</p>	<p><u>5-19-9</u></p> <p>Freestone Way, Corsham – position of bus stop.</p>	<p>Corsham TC confirm support for consideration of 3 bus stops along this route. Request review of surface type and use of grasscrete instead of tarmac to fit in with surroundings. Group agreed to allocate £2,000 for now.</p> <p>Site visit undertaken in June 2021. See attached proposals which have been sent to Corsham TC and Passenger Transport (PT) for comments. Cost estimate for each site is in the region of £3,000 (depending on the quote for Grasscrete yet to be received). If agreed not to replace the existing kerbs for bus stop kerbs and simply have a hard-standing area the costs will be reduced. PT can erect flag signs on nearby lamp columns to reduce additional street furniture.</p>	<p><u>DISCUSSION</u> KD commented that without installing kassel bus stop kerbs the price will decrease by approx. half.</p> <p><u>ACTIONS</u> Confirm support and contribution after P&A meeting. Group agreed funding if CTC confirm cheaper option & contribution.</p> <p>Request Passenger Transport erect flag signs on lamp columns at each site.</p> <p>Send example kerbs to CTC.</p>	<p>CTC</p> <p>KD</p> <p>KD</p>

h)	<p><u>5-20-5</u> Memorial Garden, Market Place, Colerne</p>	<p>Colerne PC have improved disabled access to the Memorial Gardens and are now requesting a dropped kerb and bus stop hard standing area.</p> <p>Group agreed to move to top priority when resources are available. Site visit with Colerne PC to be undertaken once Covid-19 national lockdown restrictions are eased.</p> <p>Site meeting undertaken in May 2021. Please see attached proposal plan, the cost estimate is in the region of £3,200 (CATG: £2,400. 25% contribution: £800).</p>	<p><u>DISCUSSION</u> Colerne PC have a meeting next week where this will be discussed. All agreed to fund the scheme if Colerne agree and confirm contribution. Colerne to install heritage lighting at own expense, coordinate with Wiltshire Council to implement.</p> <p><u>ACTION</u> Confirm contribution & time scale for heritage lighting.</p>	Colerne PC
i)	<p><u>5-20-8</u> Leafy Lane, Rudloe, Box</p>	<p>Referred to previous proposal submitted 2/3 years ago. Group agreed to revisit this issue and move to top priority when resources are available. BA arranged virtual meeting to discuss issues held on 11/01/21. Site visit undertaken by KD to assess the site further. To be discussed at the meeting. Discussed previous proposal and information on this project so far. Box PC confirmed they are supportive of the issue. BA requested additional coloured surfacing to the proposal. Highway officers discussed the pros/cons to this element on the maintenance side of things. Group agreed to allocate £1,000 for now.</p> <p>Proposal plan attached and updated estimate sent to Box PC for review in May 2021. Cost in the region of £3,800 (CATG: £2,850. 25% contribution: £950)</p> <p>Box PC email 15/6/21 – requested the CATG put this scheme on hold until further options have been considered.</p>	<p><u>DISCUSSION</u> Box PC confirmed this should be put on hold while they are considering other options.</p> <p><u>ACTIONS</u> Remove from priority list and move to other priorities. SSE fence obstructing visibility Cllr Walters agreed to meet PC on site to discuss further.</p>	KD DW

5.	Other Priority Schemes		
a)	<p><u>Issue 6829</u></p> <p>Lacock village – restriction for tourist coach restriction.</p>	<p>Preliminary design sent to Lacock Parish Council for consideration. The estimated costs of this scheme including data collection surveys before and after to analyse success of signing scheme is in the region of £6,000. A 25% contribution would be £1,500. Lacock PC confirmed they do not support this proposal. Subsequently withdrawn and issue removed from priority list. Lacock PC to escalate the issue at strategic level. Group agreed to leave on agenda for now.</p> <p>Lacock PC explained they have written to Western Gateway regarding the impact Melksham bypass will have on the village and coaches. Requests for strategic plan made to Cllr Wayman and MP Michelle Donelan. It was also suggested to contact Cllr Philip Whitehead – Leader of Wiltshire Council to highlight these issues further. No further action currently.</p>	<p><u>DISCUSSION</u></p> <p>Leave on agenda for now and monitor. Melksham Bypass route selection process might have an impact on this issue in the future.</p>

<p>b)</p>	<p>5-20-2 Lacock Road, Corsham – verge deterioration, request for footway/kerbing installation.</p>	<p>Request for new footway and kerb line along Lacock Road on the southern side for the extent of the properties.</p> <p>PW explained the issues with parents parking on the double yellow lines and issues being cause by the muddy verge for residents. A footway along the south side of Lacock Road has been looked at before through TAOSJ in 2010 and 2015 but was not recommended due to large scale drainage works and relocation of utilities. It was felt this solution would also encourage more parents to drive and park if there was a footway introduced.</p> <p>GW confirmed road markings are in place and visible. KD has requested targeted enforcement by Parking Services team at school times. Ball park figure supplied to Corsham TC for kerbing works. In the region of £20,000 – £25,000. Concerns over safety and parking issues surrounding the school. Request for investigation into school keep clear markings, no loading restriction. Possible scheme for future substantive bid funding. Group agreed to allocate £2,000 for now</p> <p>Site visit undertaken in June 2021 and discussed with David Arnup. Utility identification and gully clearing work to be carried out prior to finalising any design or cost estimate for this project.</p>	<p>ACTIONS Carry out gully clearing and utility identification.</p> <p>Look at scheme viability/costs after drainage system and utilities are established.</p>	<p>DA</p> <p>KD</p>
-----------	--	---	---	---------------------

<p>c)</p>	<p><u>5-21-1</u> Notton Lane/Chequers Hill junction with A4, Corsham</p>	<p>Corsham Court Estate are concerned about vehicles being parked immediately in front of the gated entrance to the lower estate field despite a warning notice. Cars regularly park here to access the footpaths in the park, and this is preventing access to check on and feed the sheep. Matters are expected to get worse because WC has just resurfaced the verge area by the gate making parking easier.</p> <p>Request for two small bollards, one either side of the gate, which will allow farm vehicles to access the field but deter parking across the gate. Corsham TC support this issue on the basis that Corsham Estate allocate 50% of funding. Design and estimate to be completed when resources allow this issue to reach top priority list.</p>	<p><u>DISCUSSION</u> JW contacted estate regarding contribution but waiting for cost estimate before confirming. After meeting Cllr Walters confirmed with Corsham Estate this is no longer an issue as the problem is intermittent and can be resolved by placing cones when access is required.</p> <p><u>ACTION</u> Remove and close.</p>	<p>KD</p>
<p>d)</p>	<p><u>5-21-2</u> B3109 Bradford Road, Rudloe</p>	<p>Request for a safe crossing to be installed, for example a formal signal-controlled crossing. Box PC raised concerns over residents of Redcliffe development on journeys to school. Gap in footway not allowing practical use of new Toucan crossing from this location. The Parish Council requests that the speed limit on the B3109 be reduced from 50 mph to 30 mph on the stretch of the road going from the mini fiveways junction at the top of Westwells Road, past the housing development and the access to Corsham Primary School. The Parish Council would also request a reduction to 20 mph at school opening and closing.</p> <p>As specified in DfT circular 01/13 Setting Local Speed Limits, speed limits should not be used to attempt to solve an isolated issue, the provision of adequate footways in rural locations is a more effective way to improve pedestrian safety than lowering the speed limit over a short distance. The Bellway site plan shows a footway link east of the Dickens Gate development connecting with Skynet Drive. Once this is constructed it is suggested this route is promoted for a safer route to school. Discuss option of substantive bid for a footway from the eastern development to link with toucan crossing. Topographical survey required to progress.</p>	<p><u>DISCUSSION</u> Cllr Walters expressed concerns relating to the speed limit and highlighted concerns over whether this issue is being fully addressed. Box PC commented they are unhappy about position of toucan crossing requesting a site meeting. Headteacher proposes reduction in speed limit with option for flashing 20mph advisory speed limit.</p> <p>Cllr Hopkinson gave a comprehensive background on the toucan crossing connection with Skynet Drive and reasoning behind it in relation to the development.</p> <p>All agreed this should be a top priority when space is available. Full discussion on solutions at that time.</p>	

e)	<p><u>5-21-3</u> Pool Green / Elley Green junction, Neston, Corsham</p>	<p>Concerns over pedestrian safety as no footpath at this junction and visibility is limited. Parents do not like walking this section with buggies and young children as do not feel safe as there is no proper footpath and traffic does not slow down to turn into junction. This road is busy at school times and with a bus route.</p> <p>Preschool numbers have increased due to closure of Cotswold Centre and new housing meaning more pedestrians using this route. Pedestrian movements in this area are difficult due to limited visibility at this junction and lack of footway. Corsham TC support this issue and agree to fund any survey work plus 25% towards implementation up to £5,000. Group supports issue.</p> <p>Design and estimate to be completed when resources allow this issue to reach top priority list.</p>	<p><u>DISCUSSION</u> All agreed to leave this issue on the agenda until space on priority list becomes available.</p>	
f)	<p><u>5-21-4</u> Prospect, Box</p>	<p>Concerns regarding the danger to horse riders along this route. Request for horse warning signs to raise awareness of potential danger.</p> <p>Box PC actioned with collecting data evidence to present at this meeting.</p>	<p><u>DISCUSSION</u> Box PC confirmed no evidence has been collected yet.</p> <p><u>ACTION</u> Collect evidence for next meeting.</p>	Box PC
g)	<p><u>5-21-6</u> Boxfields Road crossroads junction with White Ennox Lane</p>	<p>The Parish Council request that a crossroads warning sign be erected on Boxfields Road in advance of this junction to reduce the danger of farm vehicles using this junction.</p> <p>Box PC actioned with collecting data evidence to present at this meeting.</p>	<p><u>DISCUSSION</u> Box PC contacted agricultural contractor who confirmed approx. 12 tractors a day exiting junction.</p> <p><u>ACTIONS</u> Send information to KD.</p>	Box PC

h)	<p><u>5-21-8</u> Ogbourne, off the High Street, Colerne</p>	<p>Ogbourne is a cul-de-sac off High Street. The first part is adopted highway but there is an unadopted section servicing 5 dwellings. Delivery vehicles are driving into the lane and causing damage to walls and residents' cars because there is nowhere to turn around.</p> <p>Request for signing to discourage commercial vehicles from entering the lane.</p> <p>Colerne PC actioned with collecting data evidence to present at this meeting.</p>	<p><u>DISCUSSION</u> Colerne PC confirmed no further incidents since this issue was raised. Leave on agenda but all agreed no further action for now.</p>	
i)	<p><u>5-21-9</u> Fosse Way / Bath Road junction, Colerne</p>	<p>Concerns over vehicle accidents along this route and around the bend. Requests for a review of signing along this route, in particular speed limit signing and reduction to 50mph.</p> <p>Colerne PC and BM commented on safety concerns along this route and request a signing review. Group agreed with issue and suggest a review is carried out when priority list and resource permits.</p>	<p><u>DISCUSSION</u> All agreed to leave this issue on the agenda until space on priority list becomes available.</p>	
j)	<p><u>5-21-10</u> A350 Lacock, Lackham roundabout to proposed Melksham Bypass location</p>	<p>Lacock Parish Council request that a survey is carried out of the A350 and its junctions from Lackham roundabout to the location of the junction with the proposed Melksham bypass to ensure compliance with appropriate standards and are fit for the purpose of carrying the projected increased traffic volumes.</p> <p>Lacock PC and Notton resident outlined issue along this route as well as future concerns when the Chippenham duelling project and Melksham Bypass is complete. Group agreed this is not an issue the CATG have capability to resolve as it requires a more strategic approach.</p> <p>KD contacted the major projects team, the response is attached to end of this agenda. The response has been shared with Lacock Parish Council and Wiltshire Councillor.</p>	<p><u>DISCUSSION</u> LPC expressed concerns over this section of A350 being fit for purpose. All agreed this is beyond the scope of CATG.</p> <p><u>ACTIONS</u> Pursue issue directly with Highways Provide Cllr Walters with contact for Major Projects team. Remove and close.</p>	<p>LPC/DW KD KD</p>

6.	New Requests / Issues		
a)	<p><u>5-21-11</u> Colerne, Quarry Lane/Forrester Green - footway</p>	<p>Request for new footway on south east side of Forrester Green at its junction with Quarry Lane immediately opposite Colerne Primary School. Cllr Mathew received request from resident for footway across small area of the verge to allow pedestrian and mobility scooter users to have easier access to Quarry Lane.</p> <p>To be discussed at the meeting.</p>	<p><u>DISCUSSION</u> DA confirmed footway funding is for maintaining existing not new infrastructure projects. All agreed to close and remove. Colerne PC to liaise with Cllr Mathew accordingly.</p> <p><u>ACTION</u> Remove and close Inform original requester</p> <p>KD Colerne PC</p>
b)	<p><u>5-21-12</u> Corsham Park Lane - Speed limit</p>	<p>The Town Council has received a number of comments from residents in the new developments off Park Lane about the need to reduce the speed limit at the western end of the road. At present Park Lane has a 30mph limit from its junction with the A4 to the Peel Circus turning. The area from Peel Circus to Westwells Road is a 40mph limit. It could be argued that the nature of the road has changed (following the building and occupancy of the new housing) and that a 40mph limit might no longer be appropriate. This is especially true for the section between Peel Circus and Hudswell Lane.</p> <p>To be discussed at the meeting.</p>	<p><u>DISCUSSION</u> All agreed to leave this issue on the agenda until space on priority list becomes available.</p>

c)	<p><u>5-21-13</u> Gastard, Velley Hill - speeding</p>	<p>Residents concerned over speeding traffic on Velley Road, Corsham causing safety issues for residents, visitors and horse riders in the village. Request for physical traffic calming measures to be introduced to slow the traffic down.</p> <p>To be discussed at the meeting.</p>	<p><u>DISCUSSION</u> Cllr Walters agreed to progress this issue outside the CATG via SID deployment. All agreed to remove and close.</p> <p><u>ACTION</u> Remove and close Inform original requester</p>	<p>KD CTC</p>
d)	<p><u>5-21-14</u> Corsham, A4 Pickwick junction with Middlewick Lane</p>	<p>Residents concerned about safety in crossing the A4 at Pickwick in the vicinity of Middlewick Lane. There is current no formal crossing and many dog walkers, parents with children and joggers cross at this location. Traffic is speeding through the village in excess of the 30mph speed limit. Request for signal-controlled crossing.</p> <p>To be discussed at the meeting.</p>	<p><u>DISCUSSION</u> All agreed to leave this issue on the agenda until space on priority list becomes available to investigate a pedestrian survey.</p>	
e)	<p><u>5-21-15</u> Corsham, Park Place Development – Groundstone Way</p>	<p>The end of Groundstone Way closest to Hartham Quarry is experiencing a number of vehicles attempting to get onto Bradford Road to which there is no access, including large HGVs following their satnav. Request for No through Road sign.</p> <p>To be discussed at the meeting.</p>	<p><u>DISCUSSION</u> KD confirmed this is not adopted highway. Cllr Walters suggest contacting Ordnance Survey to amend Sat Nav info.</p> <p><u>ACTIONS</u> Ordnance survey contact to HB Speak with section 38 inspector. Remove and close. Inform original requester.</p>	<p>DW GW KD CTC</p>

f)	<p><u>5-21-16</u> Corsham, Beechfield Road – Parking issues</p>	<p>Parking in the turning area behind 10-12 Beechfield Road is preventing access to the garages of these properties. Request for hatching in the area adjacent to the garages to prevent parking and allow residents access to their garages.</p> <p>To be discussed at the meeting.</p>	<p><u>ACTION</u> All agreed to leave on agenda for now and Cllr Hopkinson to contact Police regarding enforcement.</p>	RH
g)	<p><u>5-21-17</u> Corsham, Potley Lane – Congestion and speeding</p>	<p>Congestion and speeding on the stretch of Potley Lane between the Leafield Industrial Estate and Potley Bridge, especially the middle section where the carriageway becomes single lane due to on street parking. Request for speed reduction measures such as traffic calming/20mph speed limit. Possibly widening the carriageway through the narrow section if feasible.</p> <p>To be discussed at the meeting.</p>	<p><u>DISCUSSION</u> All agreed to leave this issue on the agenda until space on priority list becomes available.</p>	

7.	AOB		
	Highways Asset Management 5-year plan	<p>Please see below link to the Highways Asset Management 5-year maintenance plan from Wiltshire Council's website for your information:</p> <p>Scroll down to Wiltshire Highways Maintenance Plan Corsham 2021-2025</p> <p>https://www.wiltshire.gov.uk/highways-asset-management</p> <p>Please address any queries to the relevant Area Highway Engineer.</p>	
8.			
	Date of Next Meeting	29 th September 2021 @ 14:00 via MS Teams	

Corsham Community Area Transport Group

Highways Officer – Kate Davey

1. Environmental & Community Implications

1.1. Environmental and community implications were considered by the CATG during their deliberations. The funding of projects will contribute to the continuance and/or improvement of environmental, social and community wellbeing in the community area, the extent and specifics of which will be dependent upon the individual project.

2. Financial Implications

2.1. All decisions must fall within the Highways funding allocated to Corsham Area Board.

2.2. If funding is allocated in line with CATG recommendations outlined in this report, and all relevant 3rd party contributions are confirmed, Corsham Area Board will have a remaining Highways funding balance of **£13,179.91**

3. Legal Implications

3.1. There are no specific legal implications related to this report.

4. HR Implications

4.1. There are no specific HR implications related to this report.

5. Equality and Inclusion Implications

5.1 The schemes recommended to the Area Board will improve road safety for all users of the highway.

6. Safeguarding Implications

6.1 There are no safeguarding implications

7. Recommendations

Corsham Area Board are asked to approve recommendations

Corsham CATG

FINANCIAL SUMMARY

BUDGET 2021-22

£10,819.00	CATG Allocation 2021-22
	Previous years £10,951.00
£31,785.91	2020-21 Underspend

Contributions

Corsham Town Council - Park Lane Parking Restrictions	£0.00	Confirmed - on hold (£1000 TBA)
Lacock Parish Council - High St/West St mini roundabout design work	£1,250.00	Confirmed
Lacock Parish Council - bridge speed limit extension implementation	£1,750.00	Confirmed
Corsham Town Council - 20mph speed limit assessment	£625.00	Confirmed
Corsham Town Council - Pickwick Road Warning Sign	£175.00	Confirmed
Corsham Town Council - Cross Keys 50mph speed limit implementation	£1,750.00	TBC
Corsham Town Council - Freestone Way Bus Stops	£1,125.00	TBC cheaper option
Corsham Town Council - Lacock Road Kerbing & waiting restrictions		
Box Parish Council - Leafy Lane dropped kerb crossing point & signs		On hold at request of Box PC
Colerne, Market Place Memorial Garden dropped kerb and hard standing	£800.00	TBC

Total Budget

£50,079.91

Commitments

Corsham Park Lane parking options	£4,000	Estimate - on hold
Lacock High St/West St mini roundabout design work	£5,000	Estimate

New Schemes

Lacock bridge pedestrian improvements - speed limit implementation	£7,000	Estimate
Corsham 20mph speed limit assessment	£2,500	Estimate
Corsham, Pickwick Road Warning Sign	£700	Estimate
Corsham, Cross Keys 50mph speed limit implementation	£7,000	Estimate
Corsham, Freestone Way bus stops	£4,500	Estimate for cheaper option
Corsham, Lacock Road kerbing & waiting restrictions	£2,000	Allocated March 2021
Box, Leafy Lane dropped kerb crossing point and signing		On hold at request of Box PC
Colerne, Market Place Memorial garden dropped kerb and hard standing	£3,200	Estimate
Lacock High St/West St mini roundabout substantive bid contribution	£1,000	CATG Contribution

Total Spend / Commitments £36,900.00

Remaining Budget £13,179.91

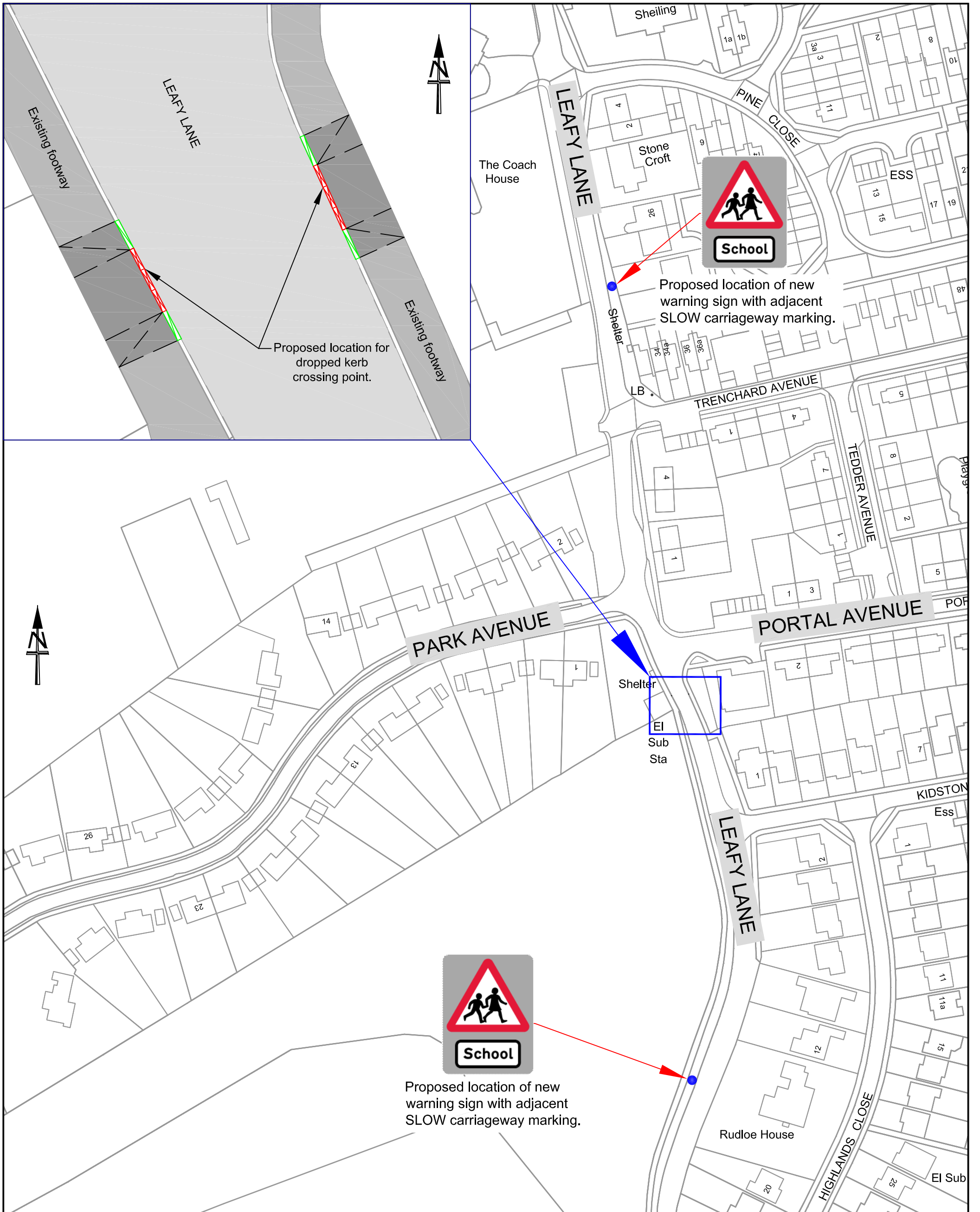

NOTES:

Wiltshire Council
Where everybody matters

Traffic & Network Management

County Hall, Bythesea Road, Trowbridge
Wiltshire, BA14 8JD

Tel: 0300 4560100
Website: www.wiltshire.gov.uk

This map is reproduced from Ordnance Survey material with the permission of Ordnance Survey on behalf of the Controller of Her Majesty's Stationery Office © Crown copyright.

Unauthorised reproduction infringes Crown Copyright and may lead to prosecution or Civil Proceedings.

Wiltshire Council (100049050) 2018

F					
E					
D					
C					
B					
A					
O	27/04/18	K.A.D	D.M.T	D.M.T	ORIGINAL
REV	DATE	DRAWN	CHECK	APPRV	DESCRIPTION

PROJECT:		
Corsham CATG Scheme Leafy Lane, Box		
DRAWING TITLE:		
Dropped Kerb Crossing Point PRELIM DESIGN		
SCALES:	NOT TO SCALE	SHEET SIZE: A3
DRAWING No.	KAD/CATG/BOX	REVISION: 0
FILE REF:	L:\TET\AB\Corsham\CATGschemes\LeafyLaneCorsham	

DRAWING PURPOSE:
PRELIM DESIGN

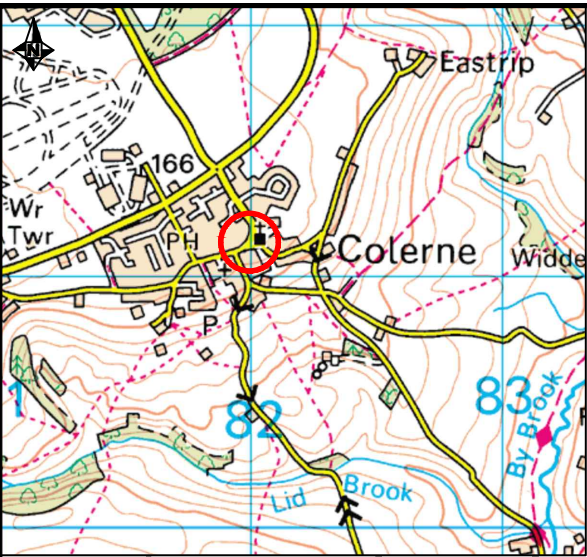

Footway/grasses area to be resurfaced
Siding to carriageway required

New dropped kerbs re-use stone kerbs where possible (depends how they come out of ground) if not suitable new conservation kerbs to be used.

Existing bus shelter

Footway to be resurfaced to remove current trip hazard from change in surface levels.

Existing lamp column. Parish Council to confirm if they are changing it to an ornamental column and timeframe for that change.

Footway to be resurfaced to provide hard standing

Existing parking bays to be suspended for duration of works (5 days) to reduce the need for a full road closure.

NOTES:

This map is reproduced from Ordnance Survey material with the permission of Ordnance Survey on behalf of the Controller of Her Majesty's Stationery Office © Crown copyright.
Unauthorised reproduction infringes Crown Copyright and may lead to prosecution or Civil Proceedings.
Wiltshire Council (100049050) 2021



Traffic & Network Management

County Hall, Bythesea Road, Trowbridge
Wiltshire, BA14 8JD

Tel: 0300 4560100
Website: www.wiltshire.gov.uk

F					
E					
D					
C					
B					
A					
O	5/21	SLD	KD	KD	ORIGINAL
REV	DATE	DRAWN	CHECK	APPRV	DESCRIPTION

DRAWING PURPOSE:

PRELIMINARY

PROJECT:

Colerne
Market Cross

DRAWING TITLE:

Footway Improvements
Preliminary Design

SCALES:	NOT TO SCALE	SHEET SIZE:	A4
DRAWING No.	2021-017/SLD/COLE/D001	REVISION:	0
FILE REF:	L/TET/CATG/Corsham		

A350 LACOCK – RESPONSE FROM MAJOR PROJECTS TEAM

There are no plans to include the whole length of the A350 as it passes Lacock within the scope of the Melksham Bypass project. That said, limited sections to the south of Lacock and towards Beanacre may be included, and to the north of Lacock the immediate approach to Lackham Roundabout might be covered in the next potential phase of the Chippenham Bypass Dualling schemes.

Please note that in terms of the Melksham Bypass route, and indeed where it may tie back into the A350 north of Melksham / Beanacre, this has still to be established. We consulted on a variety of potential options between November 2020 and January 2021. The long list of route options is currently being reduced down to a shortlist which we anticipate consulting upon further later this summer. At this stage there is no certainty regarding the project route, and as such its extent is not confirmed.

I think it is highly unlikely that the route would, in anyway, affect the A350 / Notton junction, as none of the long list route options extended that far. As such I cannot see that this would be considered or included as part of the Melksham Bypass project scope. Dependent upon route choice, and the tie-in arrangements achievable, there is some potential that the southern A350 junction at Lacock might be affected. If so it is possible that the southern junction may be included in the bypass works ... but we are some way off being in a position to confirm this either way.

The development of the short list of route options and further consultation later this year should hopefully help establish the route, and once this is know we will be able to better understand and identify the scope of the project. Lacock Parish Council would be included in the next stage of consultations.